

ST. MARY'S COLLEGE

STUDENT MEETINGS

28.08.20 – 04.09.20



PRAYER

Opening Prayer

Lord Jesus, we ask for Your help as we begin this new school year. Allow us to experience Your presence in the many blessings You put before us. Open our eyes to the new challenges and exciting opportunities that this new school year brings. Open our heart and minds to new colleagues and new students. Give us a generous spirit to be enthusiastic with our sharing and the courage to accept new opportunities. Help us to be attentive to one another and let us experience Your presence in our new academic year. Jesus, inspire us to do our best this year!

AGENDA

- I. Welcome Back
- II. Being safe in school
 - I. PPE & Hygiene
 - II. Entry and Exit
 - III. Classroom & Corridors
 - IV. Canteen & Breaks
- III. Timetable & Bells
- IV. New rules and ways of doing things
- V. What ifs?

BEING SAFE IN SCHOOL

FACE MASKS

PPE & HYGIENE: STUDENT FACE MASKS



- It is a **regulation** to wear a face covering.
- **NO** student will be allowed into school without a face mask.
- Medical exemption will allow face guard / visor.
- Students to wear face masks at all times.*
- *Students will remove the face mask correctly if necessary to remove mask for a short period (eg. Water).

PPE & HYGIENE: STUDENT FACE MASKS

- **NO** student will be allowed into school without a face mask.
- Mask must be plain / lightly patterned.
- No inappropriate logos / symbols.
- **NO** bandanas or snood type masks allowed.



PPE & HYGIENE: STUDENT FACE MASKS



- **NO** student will be allowed into school without a face mask.
- Mask to be worn on corridors and when **unable to be 2 metres apart.**
- Can be removed during rest or eating breaks.
- Can be removed outside if **2 metres apart.**
- **WASH hands regularly.**

PPE & HYGIENE:TEACHER MASK



- It is a **regulation** for teachers to wear a face covering also.
- Teacher to wear face mask if less than 2 metres from student.
- Teacher has the option of wearing *only* the visor if 2 metres or more from student.
- Teacher who may wish to move in the room must wear face mask and may also use visor.

BEING SAFE IN SCHOOL

HAND & DESK CLEANING



PPE & HYGIENE:TEACHER MASK



- It is a **regulation** for teachers to wear a face covering also.
- Teacher to wear face mask if less than 2 metres from student.
- Teacher has the option of wearing *only* the visor if 2 metres or more from student.
- Teacher who may wish to move in the room must wear face mask and may also use visor.

CLASSROOM PRACTICE: CLEANING

- Students hand sanitise on entering the classroom.
- Teacher sprays down desk.
- Student takes a wipe from wall mounted paper dispenser.
- Student cleans down desk and chair.
- Student disposes of wipe carefully in the Covid Bin.
- Process repeated at the end of class.
- It is essential that the Covid Bin is used for this form of cleaning **ONLY**.

BEING SAFE IN SCHOOL

ENTRY & EXIT

ENTRY & EXIT.

- Each Year group has a **SEPARATE** entry and exit.
- The correct entry & exit must be used each time.
- Do not be in school too early.
- Students must go directly to their **BASE** class each morning.

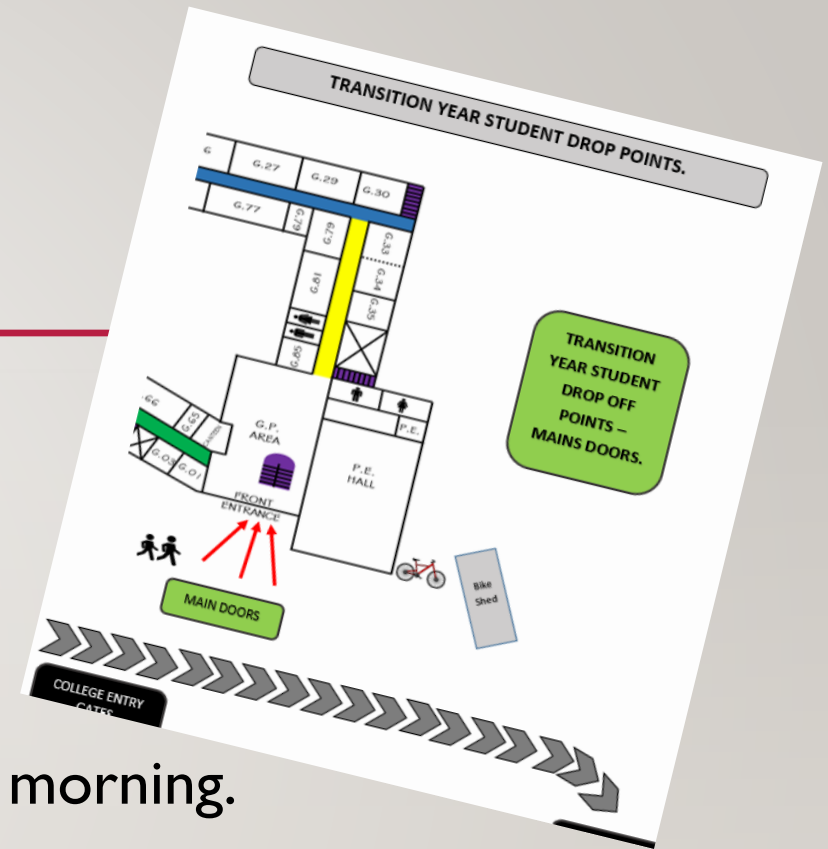

1ST YEAR

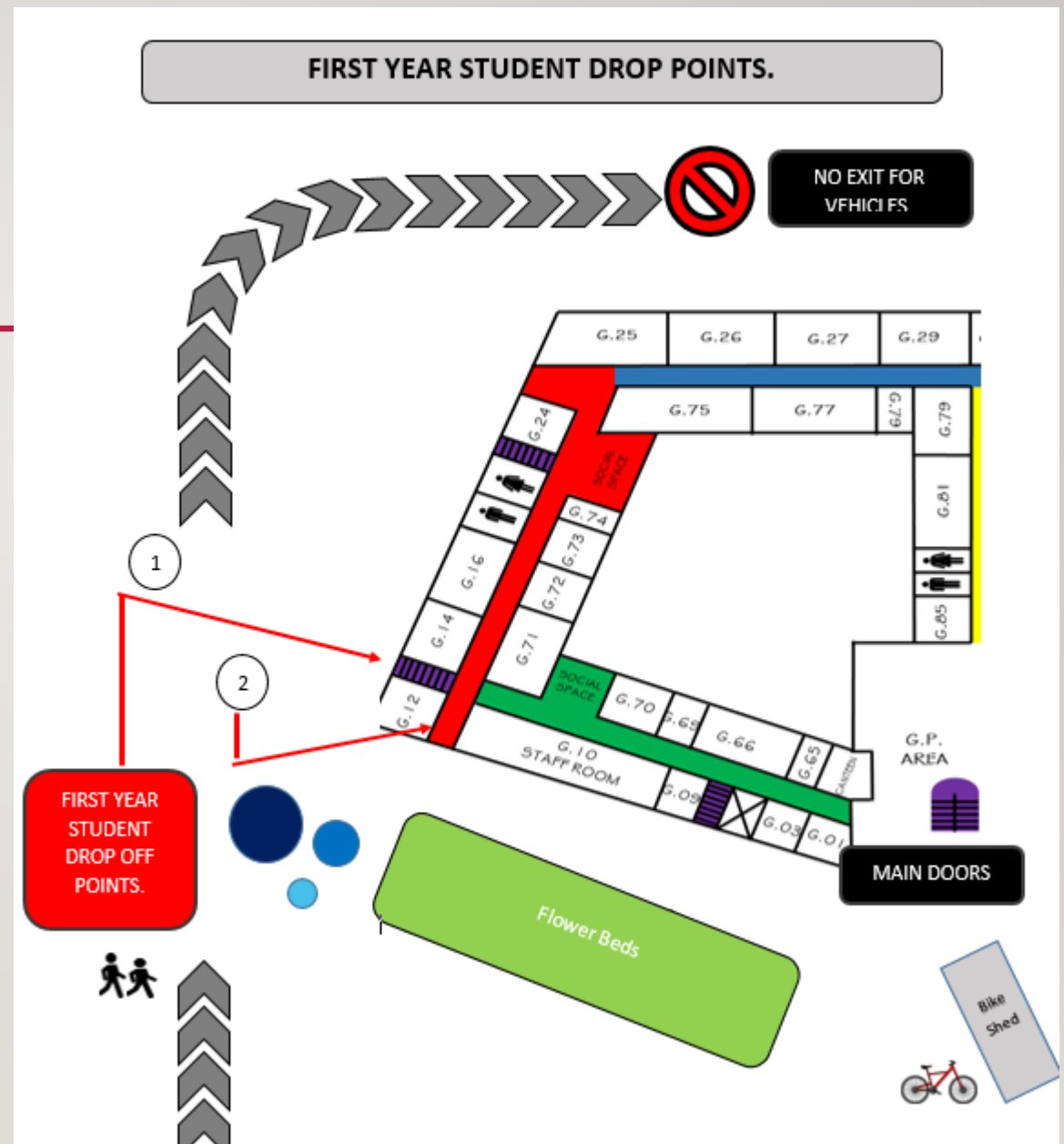

2ND YEAR

SECOND YEAR STUDENT DROP POINTS.

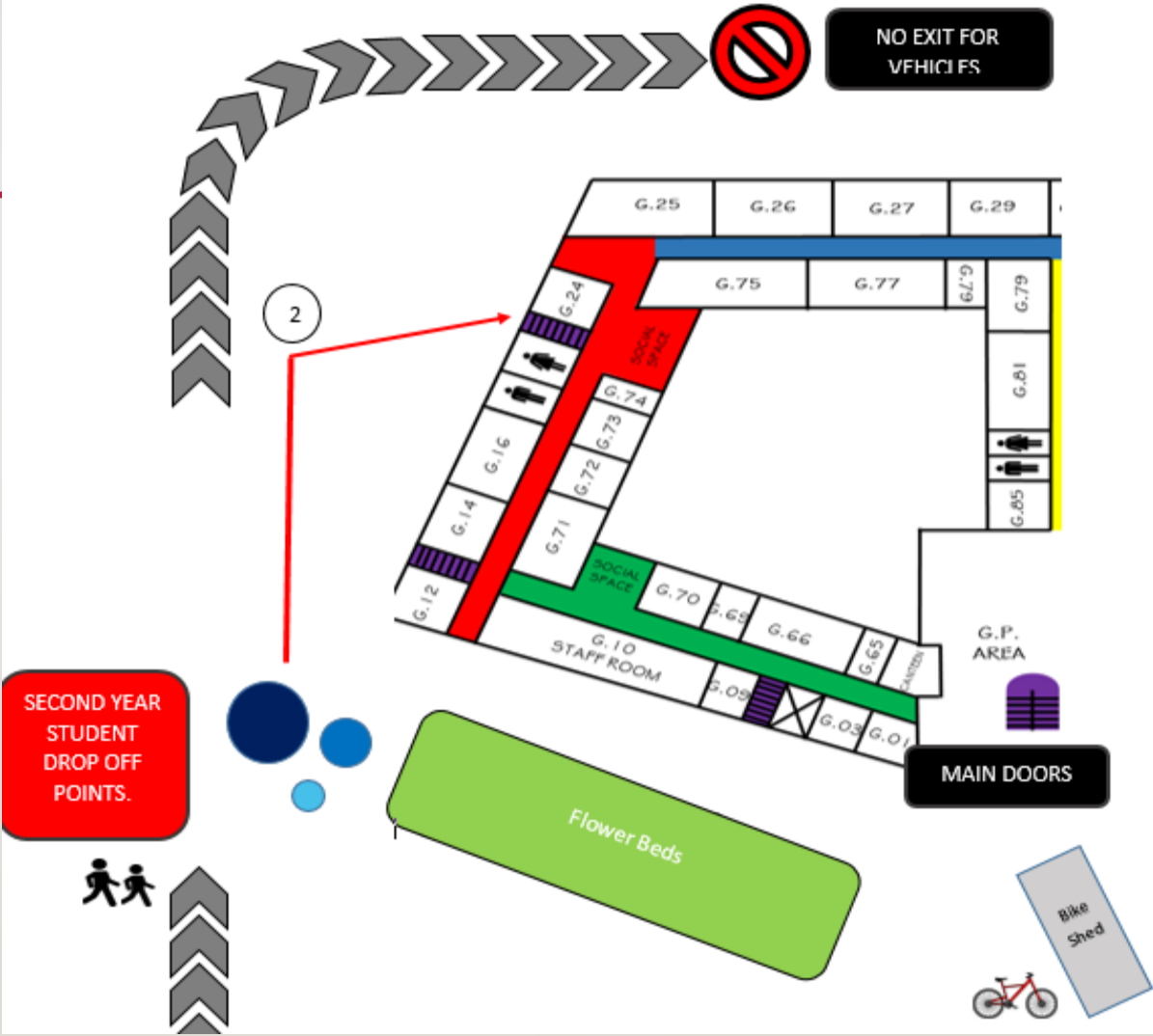

3RD YEAR

THIRD YEAR STUDENT DROP POINTS.

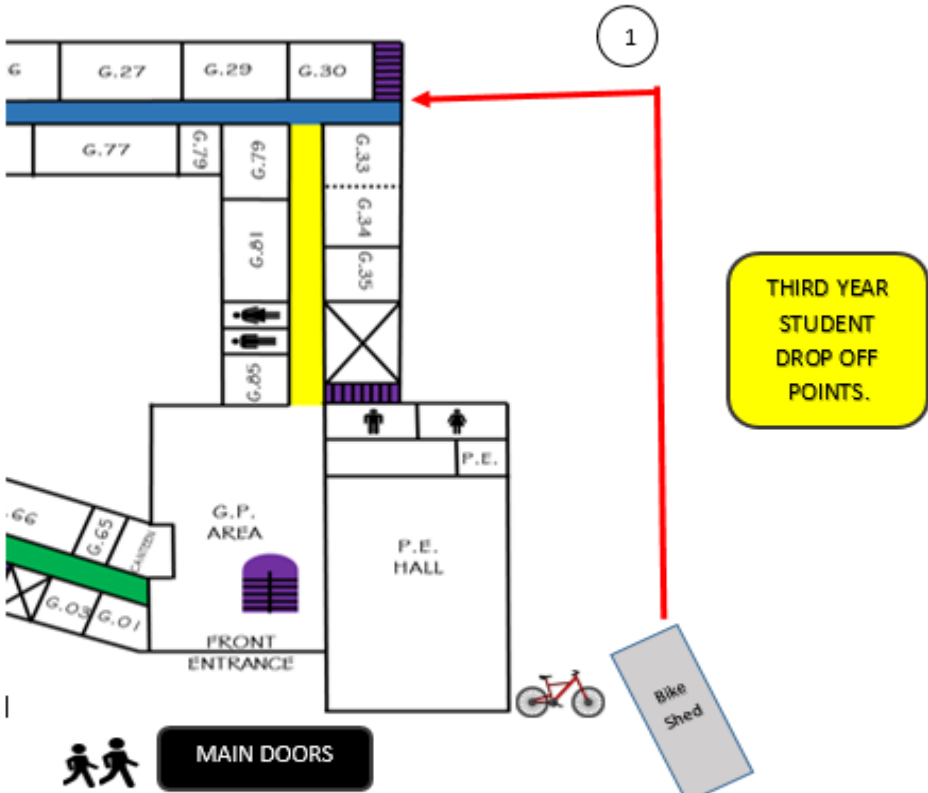

TY

TRANSITION YEAR STUDENT DROP POINTS.

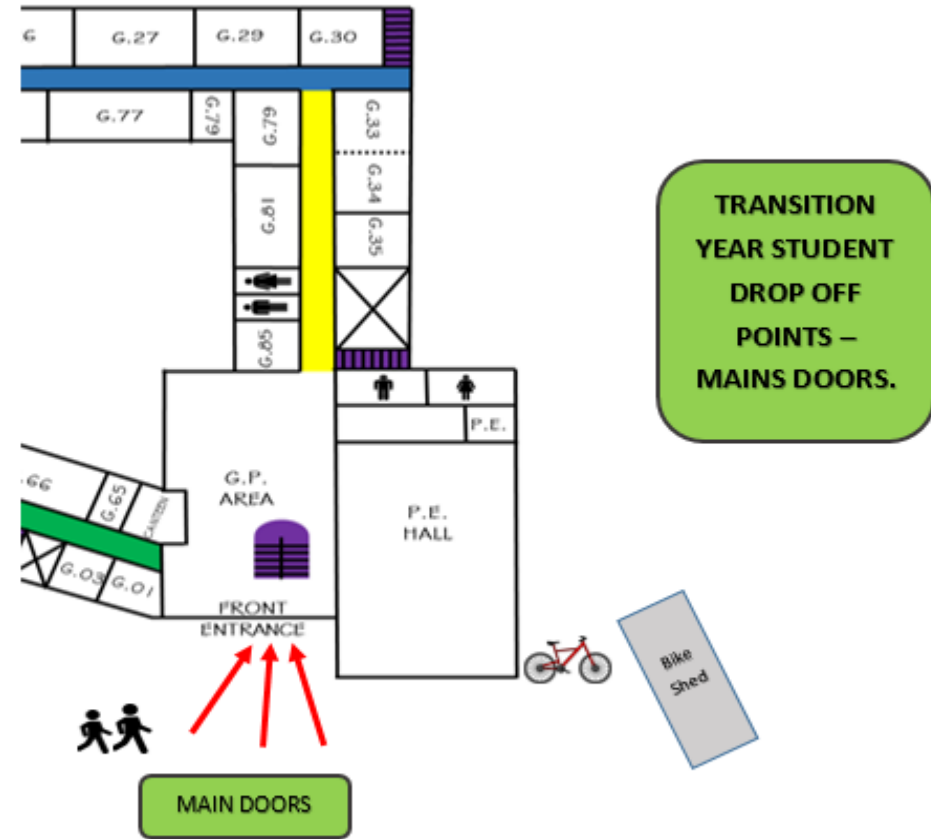

COLLEGE ENTRY
GATES

5TH

FIFTH YEAR STUDENT DROP POINTS.

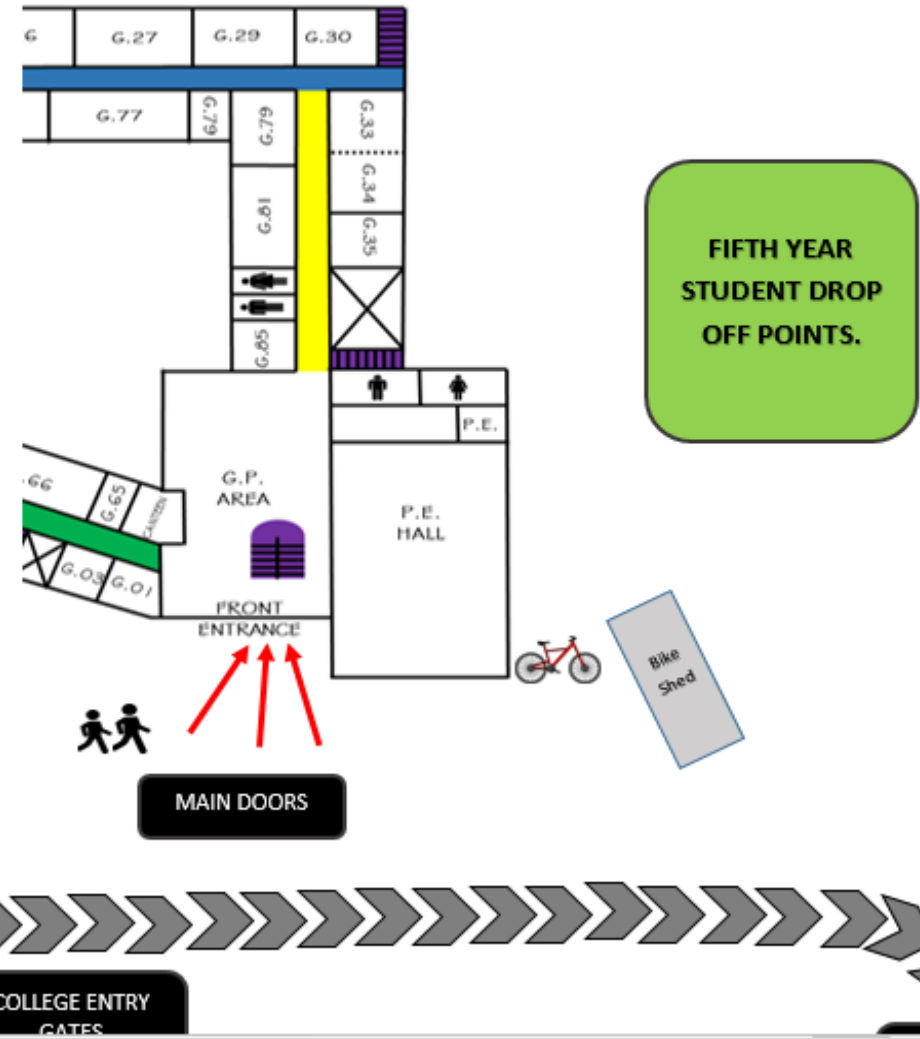

6TH

SIXTH YEAR STUDENT DROP POINTS.

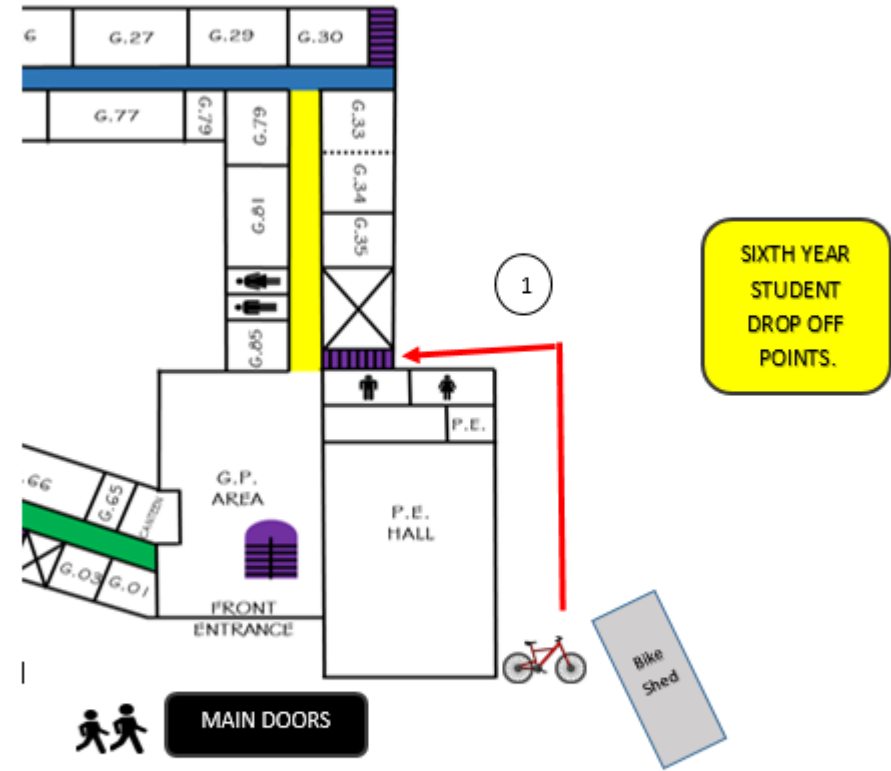

BEING SAFE IN SCHOOL

CLASSROOMS & CORRIDORS



CLASSROOMS & CORRIDORS.

- Students must go directly to their **BASE CLASS** on entering the school.
- Students must sit in their assigned **ROOM** and **SEAT** each morning.

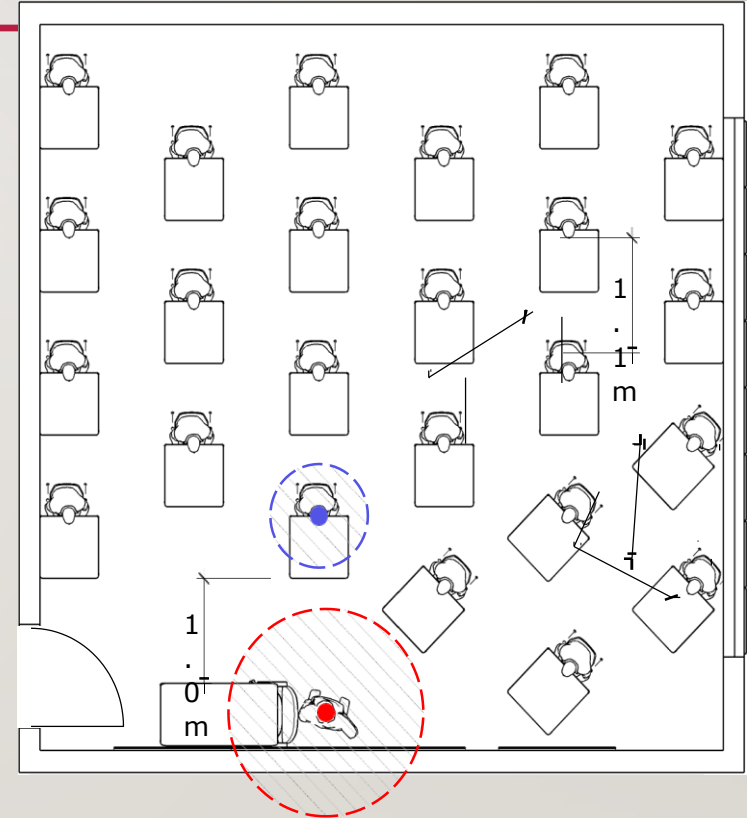

CORRIDORS.

- Students may not congregate in hallways or in other classes.
- ALL corridors have a **LEFT ONLY** walking system.



BEING SAFE IN SCHOOL

BASE CLASSES

GROUND FLOOR

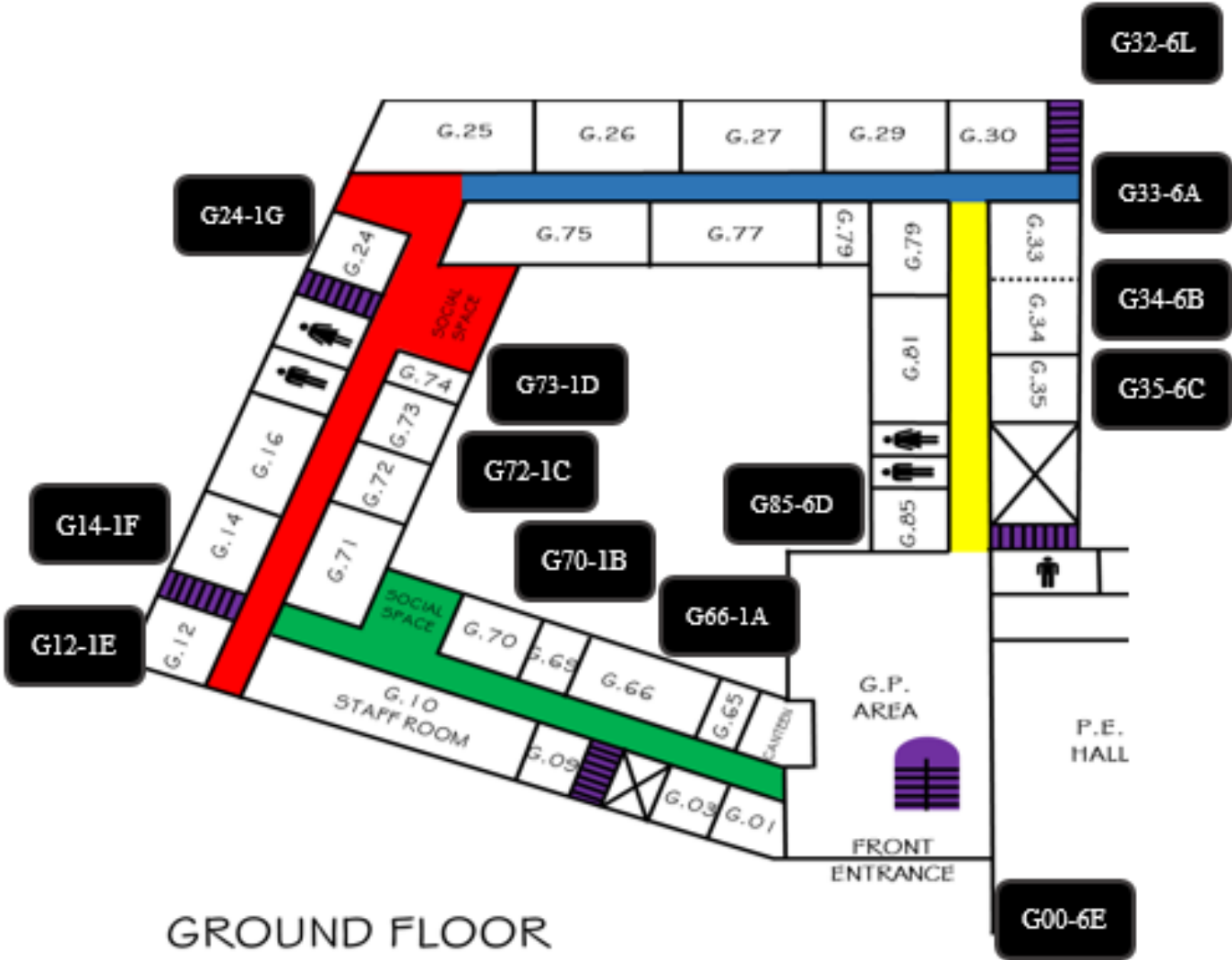

FIRST FLOOR

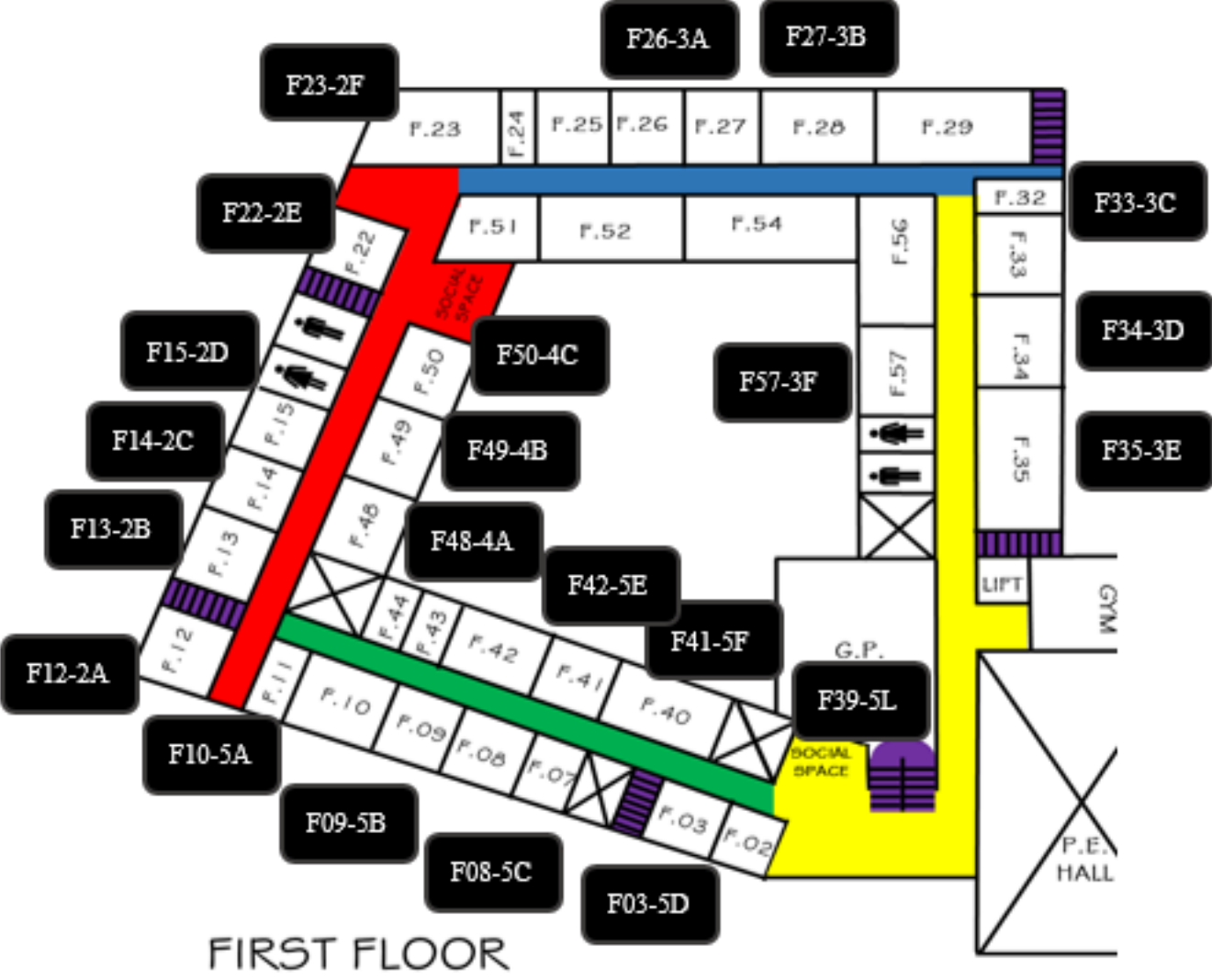

TIMETABLE & BELLS



CALENDAR 2020 – 21.

2020/21 School Calendar																																	
August 2020							September 2020							October 2020							November 2020							School Re-Opening Options.					
Wk	Mo	Tu	We	Th	Fr	Sa	Su	Wk	Mo	Tu	We	Th	Fr	Sa	Su	Wk	Mo	Tu	We	Th	Fr	Sa	Su	Wk	Mo	Tu	We	Th	Fr	Sa	Su		
31						1	2	36		1	2	3	4	5	6	40					1	2	3	4	44							1	
32	4	5	6	7	8	9		37	7	8	9	10	11	12	13	41	5	6	7	8	9	10	11	45	2	3	4	5	6	7	8	Schools Closure	
33	10	11	12	13	14	15	16	38	14	15	16	17	18	19	20	42	12	13	14	15	16	17	18	46	9	10	11	12	13	14	15	Bank Holidays	
34	17	18	19	20	21	22	23	39	21	22	23	24	25	26	27	43	19	20	21	22	23	24	25	47	16	17	18	19	20	21	22		
35	24	25	26	27	28	29	30	40	28	29	30					44	26	27	28	29	30	31		48	23	24	25	26	27	28	29		
36	31							Days		0	22					Days		17						49	30								
Days	CP																																
December 2020							January 2021							February 2021							March 2021							State Examinations					
Wk	Mo	Tu	We	Th	Fr	Sa	Su	Wk	Mo	Tu	We	Th	Fr	Sa	Su	Wk	Mo	Tu	We	Th	Fr	Sa	Su	Wk	Mo	Tu	We	Th	Fr	Sa	Su		
49		1	2	3	4	5	6	53					1	2	3	5	1	2	3	4	5	6	7	9	1	2	3	4	5	6	7	State Examinations	
50	7	8	9	10	11	12	13	1	4	5	6	7	8	9	10	6	8	9	10	11	12	13	14	10	8	9	10	11	12	13	14	Spare Days	
51	14	15	16	17	18	19	20	2	11	12	13	14	15	16	17	7	15	16	17	18	19	20	21	11	15	16	17	18	19	20	21		
52	21	22	23	24	25	26	27	3	18	19	20	21	22	23	24	8	22	23	24	25	26	27	28	12	22	23	24	25	26	27	28		
53	28	29	30	31				4	25	26	27	28	29	30	31									13	29	30	31						
Days			16					Days			18					Days		15						Days			19						
April 2021							May 2021							June 2021							July 2021												
Wk	Mo	Tu	We	Th	Fr	Sa	Su	Wk	Mo	Tu	We	Th	Fr	Sa	Su	Wk	Mo	Tu	We	Th	Fr	Sa	Su	Wk	Mo	Tu	We	Th	Fr	Sa	Su		
13				1	2	3	4	17						1	2	22		1	2	3	4	5	6	26					1	2	3	4	
14	5	6	7	8	9	10	11	18	3	4	5	6	7	8	9	23	7	8	9	10	11	12	13	27	5	6	7	8	9	10	11		
15	12	13	14	15	16	17	18	19	10	11	12	13	14	15	16	24	14	15	16	17	18	19	20	28	12	13	14	15	16	17	18		
16	19	20	21	22	23	24	25	20	17	18	19	20	21	22	23	25	21	22	23	24	25	26	27	29	19	20	21	22	23	24	25		
17	26	27	28	29	30			21	24	25	26	27	28	29	30	26	28	29	30					30	26	27	28	29	30	31			
Days			15					Days			20					Days		4															

1 HOUR TIMETABLE: JUNIOR

- Short and Long Lunch.
- Small Break is from 10.50am – 11.10am for all.
- Lunch is either at 12.10pm or 1.10pm.
- Junior Lunch: **Monday & Tuesday** @ 12.10pm – 12.50pm
- Junior Lunch: **Thursday & Friday** @ 1.10pm – 1.50pm

1 HOUR TIMETABLE: SENIOR

- Short and Long Lunch.
- Small Break is from 10.50am – 11.10am for all.
- Lunch is either at 12.10pm or 1.10pm.
- Senior Lunch: **Monday & Tuesday** @ 1.10pm – 1.50pm
- Senior Lunch: **Thursday & Friday** @ 12.10pm – 12.50pm

I HOUR TIMETABLE: JUNIOR

	Mon	Tue	Wed	Thu	Fri
P1	Art 1A BAILL G075	History A LALLC F057	French 3C MURPE F034	CSPE A BAILL F010	PE A GALLP G058GYM
P2	English A OBRID F013	Religion A WALLA F034	English A OBRID F013	Religion A WALLA F034	Geography A MULAN
B					
P3	Mathematics A FARRC F027	Mathematics A FARRC F027	Art 2A COLLA G077	Irish F LENNC F012	History A LALLC
4rL			Art 1A BAILL G075	History A LALLC F057	Mathematics A FARRC F027
Lr4	Art 2A COLLA G077	Irish F LENNC F012 R			
P5	Geography A MULAN F033	SPHE A MULLA F033		Art 1A BAILL G075	Science A MURSI F054
P6	French 3C MURPE F034	Science A MURSI F054		English A OBRID F013	Irish F LENNC F012

I HOUR TIMETABLE: SENIOR

	Mon	Tue	Wed	Thu	Fri
P1	Irish C RAFFA F041	Art 4A COLLA G077	English B CALLS F049	Biology 1D MCSHS F049	Mathematics E HEGAD F035LIB
P2	Agricultural Science 3B OHARD F025	Irish C RAFFA F041	Mathematics E HEGAD	English B CALLS F050	Agricultural Science 3B OHARD F025
B					
P3	Religion D REYNR F041	Home Economics 2C KELLB G026	Biology 1D MCSHS F049	WMOD B MORGA	English B CALLS F050
P4L	Religion D REYNR F041 R	Careers B MULAN F033	Irish C RAFFA		
LP4				Home Economics 2C KELLB G026	Art 4A COLLA G077
P5	Biology 1D MCSHS F049	Mathematics E HEGAD F035LIB		Agricultural Science 3B OHARD F025	Irish C RAFFA F041
P6	English B CALLS F049	Physical Education 3B GALLP G058GYM		Art 4A COLLA G077	Home Economics 2C KELLB G026

I HOUR BELL

Time Period	One Hour Version				
	Monday	Tuesday	Wednesday	Thursday	Friday
08.45	First Bell	First Bell	First Bell	First Bell	First Bell
08.50 P1	P1	P1	P1	P1	P1
09.50 L2	P2	P2	P2	P2	P2
10.50 Break	Start Break	Break	Break	Break	Break
11.05 Reminder	Mid Break	Mid Break	Mid Break	Mid Break	Mid Break
11.10 P3	P3	P3	P3	P3	P3
12.10 L1	P4	P4	P4	Lunch	Lunch
12.45	Mid Lunch 1	Mid Lunch 1	Mid Lunch 1	Mid Lunch 1	Mid Lunch 1
12.50 End L1	End Lunch 1	End Lunch 1	End Lunch 1	End Lunch 1	End Lunch 1
13.10 L2	Lunch	Lunch	Lunch	P4	P4
13.45 Reminder	Mid Lunch 2	Mid Lunch 2	Mid Lunch 2	Mid Lunch 2	Mid Lunch 2
13.50 P5	P5	P5		P5	P5
14.50 P6	P6	P6		P6	P6
15.50	Last Bell	Last Bell		Last Bell	Last Bell



CANTEEN



CANTEEN

- Main Canteen will be open for all breaks.
- Small Break: Main Canteen & 2 satellites (Red Corridor Up & Down)
- **Junior Lunch**
 - Main Canteen for 2nd & 3rd Years only
 - Red Corridor Lower canteen for 1st Year only.
- **Senior Lunch**
 - Main Canteen for 5th & 6th Years only
 - Yellow Corridor upper canteen for Transition Year only.



NEW RULES & WAYS OF DOING THINGS



THINK AND BE SAFE

- No action that will risk the health and safety of anyone else
- Rules on face-masks: your mask and others
- No spitting
- No chewing gum
- Use of water

COVID TRAINING:

What happens if?

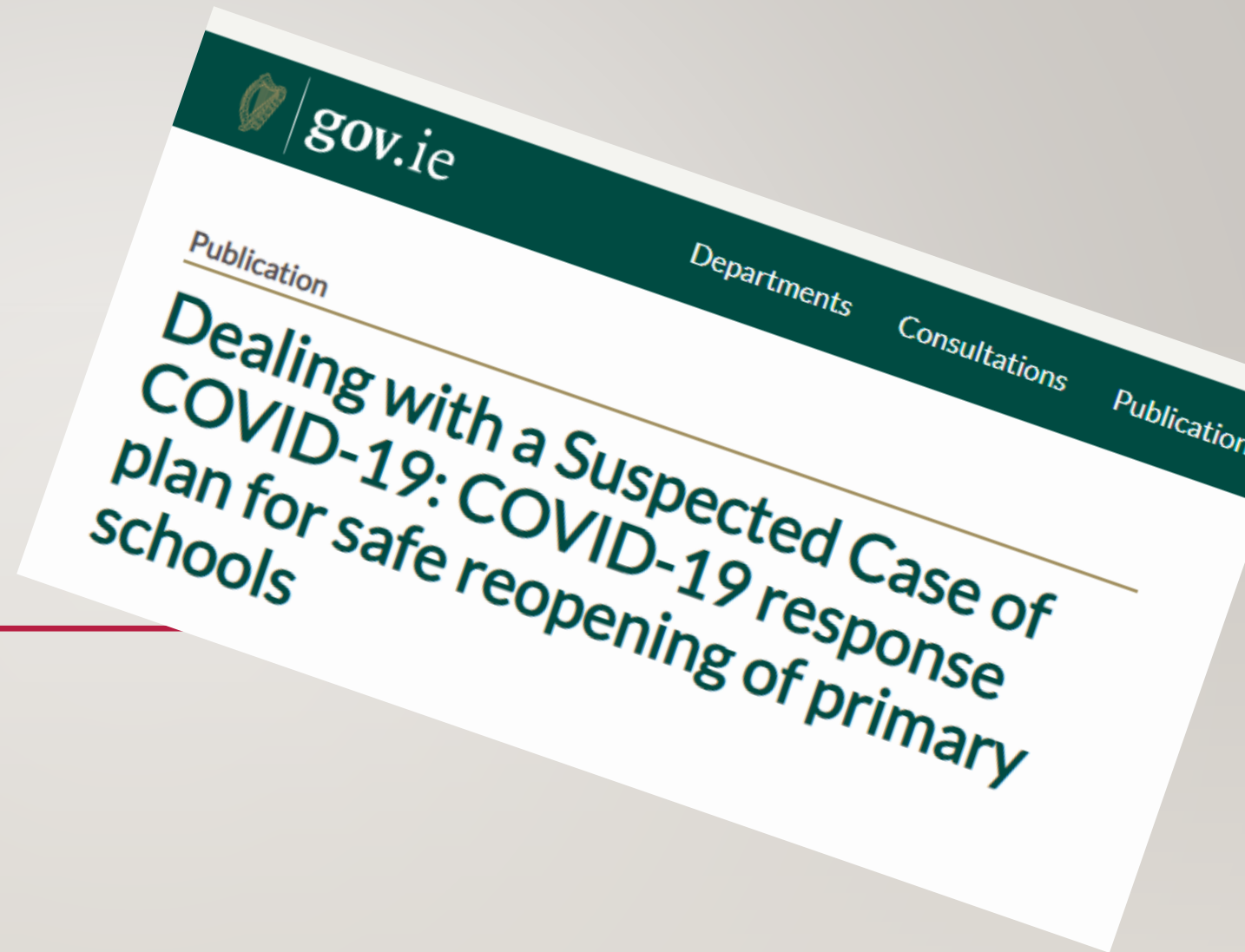

BASIC ADVICE

- Staff or pupils should **not** attend school if displaying any symptoms of COVID-19.
- The symptoms are:
 - a fever (high temperature - 38 degrees Celsius or above)
 - a cough - this can be any kind of cough, not just dry
 - shortness of breath or breathing difficulties
 - loss or change to your sense of smell or taste

Symptoms	Coronavirus Symptoms range from mild to severe	Flu Abrupt onset of symptoms	Cold Gradual onset of symptoms
Fever or chills	Common	Common	Rare
Cough	Common (usually dry)	Common (usually dry)	Mild
Shortness of breath	Common	No	No
Lost smell or taste	Common	Rare	Rare
Fatigue	Common	Common	Sometimes
Aches and pains	Common	Common	Common
Sore throat	Sometimes	Sometimes	Common
Headaches	Sometimes	Common	Rare
Runny or Stuffy Nose	Sometimes	Sometimes	Common
Feeling sick / vomiting	Rare	Sometimes	No
Diarrhoea	Rare	Sometimes in children	No
Sneezing	No	No	Common

STUDENT ARRIVES WITH NO MASK?

- It has been reiterated to parents that students cannot attend school without a face mask.
- Student is sent to office and is given a disposable mask.
- The charge is €1.
- Only after accepting mask is student allowed into school.

STUDENT ARRIVES WITH COVID SYMPTOM?

- Student is immediately taken to the Isolation Room.
- The Isolation Room is **Room G69** (Fr. Jim's old office).
- A member of SMT is contacted.
- Temperature is checked if presenting with fever as symptom.
- Parent is contacted. Student remains in supervised Isolation Room until collected.

STUDENT ARRIVES WITH COVID SYMPTOM?

- A mask is provided for the person presenting with symptoms.
- The student should avoid touching people, surfaces and objects.
- Any tissue/waste used by the student is placed in the waste bag provided.
- Arrange for appropriate cleaning of the isolation area and work areas involved.
- Advise the parent to contact GP and for child to self-isolate.

STUDENT DEVELOPS COVID SYMPTOM IN CLASS?

- Member of SMT is rung on WhatsApp (Pippa / Anita / Alan).
- SMT will collect student from room and follow procedures as in previous question.
- If no member of SMT available, remove student to corridor with chair. Send another student to office for assistance.
- Social distancing is maintained while moving student to Isolation Room.
- 2nd Isolation Room: Principal's office.

STUDENT DEVELOPS COVID SYMPTOM IN CLASS?

- Member of SMT is rung on WhatsApp (Pippa / Anita / Alan).
- SMT will collect student from room and follow procedures as in previous question.
- If no member of SMT available, remove student to corridor with chair. Send another student to office for assistance.
- Social distancing is maintained while moving student to Isolation Room

ANY QUESTIONS?

